



THE ART OF SPORTS LIVING

SPORTS VILLAS

Sports Themed Plots @

7th Parkview | Gaur Yamuna City

RERA REGN. NO.: **UPRERAPRJ16087** | www.up-rera.in

WHY YEIDA?

ARRIVE LIKE A CHAMPION

At NCR's most iconic destination

Yamuna Expressway has today evolved as one of the most vibrant real estate destinations. With a number of ongoing world-class developments and meticulous expansion, it is poised to change the face of Delhi-NCR.

- World-class 165 km Yamuna Expressway
- India's longest 6-lane controlled-access Expressway
- Installed with 'Intelligent Transport' System
- The faster connection between National Capital Region to Agra and Lucknow
- The fastest growing Economic Zone
- Home to the fast developing Noida International Airport
- Mega Industrial projects are being commissioned in the region ensuring economic upliftment
- 1000 acres Film City announced
- Another Gurgaon story getting unfolded
- Super connectivity with approved metro and proposed Mono-Rail projects
- Zip drive to Noida and Gr. Noida in 15-20 minutes
- The Only F1 circuit in the Country
- Multiple Industrial Hubs being developed such as Textile Zone, Electrical Zone and Toy City
- YEIDA region is currently the economic hotspot of the country.

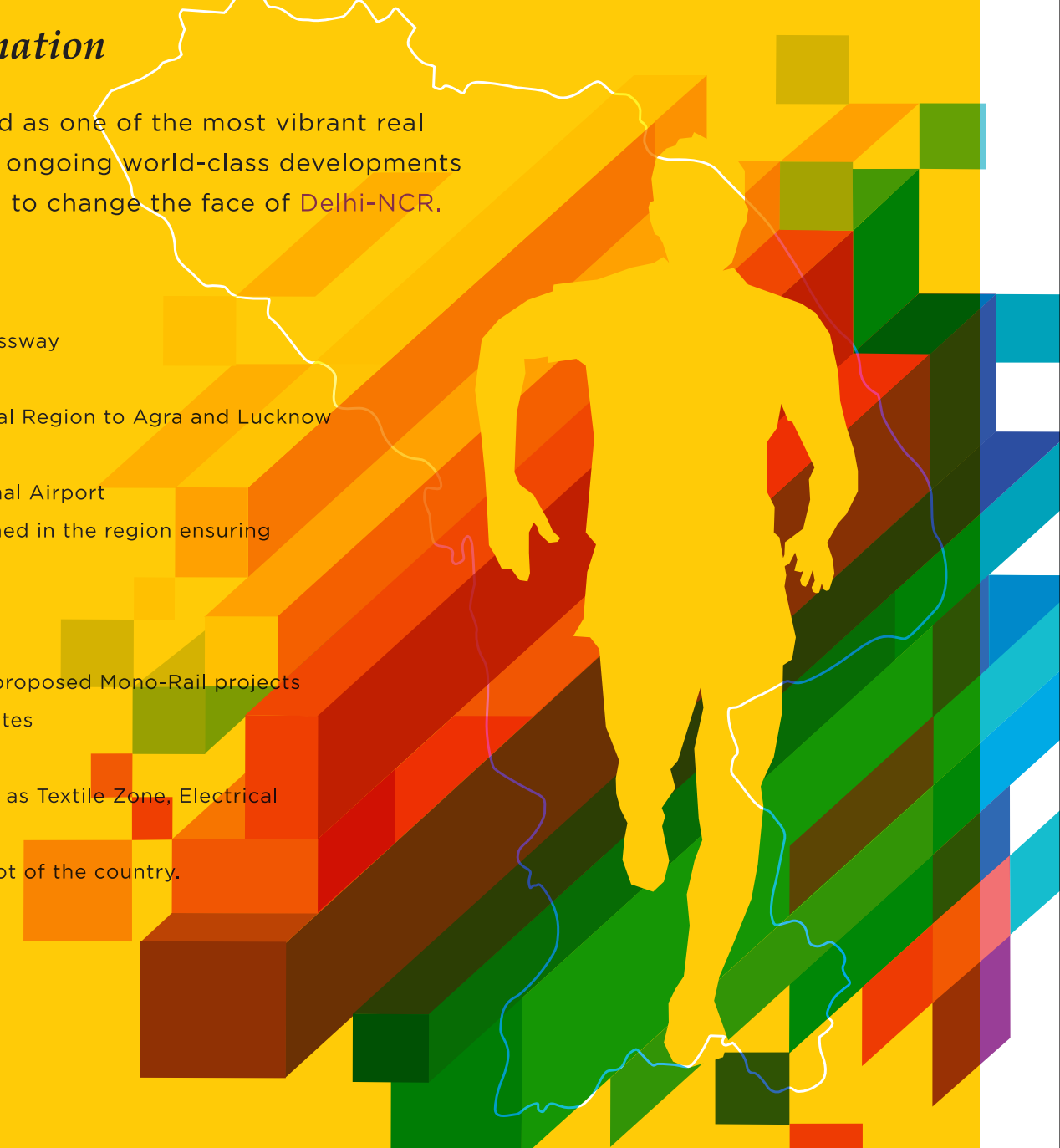

Disclaimer:
The image/images used above is for illustrative purposes only. All images including stock images, colours, pictures and accessories are indicative and used for illustrative purposes only. For the actual project details, please refer to the specifications mentioned in the subsequent pages of this brochure.



THE THRIVING IT HUB

A large number of IT & ITES companies

Various big companies are opening up

GROWING JOB OPPORTUNITIES

MODERN INFRASTRUCTURE

Wider roads with huge scope for expansion

Modern shopping malls & commercial spaces

WORLD-CLASS HOSPITALS, SCHOOLS, COLLEGES & OTHER EDUCATIONAL INSTITUTES

PROGRESSIVE GOVERNMENT INITIATIVES & SCHEMES

Investment-friendly infrastructure

Industrial parks, entertainment zones and SEZ's being developed

FAVOURITE AMONGST BIG INVESTORS

Aatm-Nirbhar Bharat - Homegrown Tech giant Intex is also looking for a big-time investment in Greater Noida.

Already made a deal of

650 CRORES

right along Yamuna Expressway

Textile Park on 200 acres of land will generate

5 LAKH JOBS

Microsoft is likely to set up new 4,000-employee campus near the Upcoming Noida International Airport-the second-largest in India

*All information above is in reference from newspapers, websites and news portals.

STAY AHEAD OF THE GAME

With endless growth opportunities

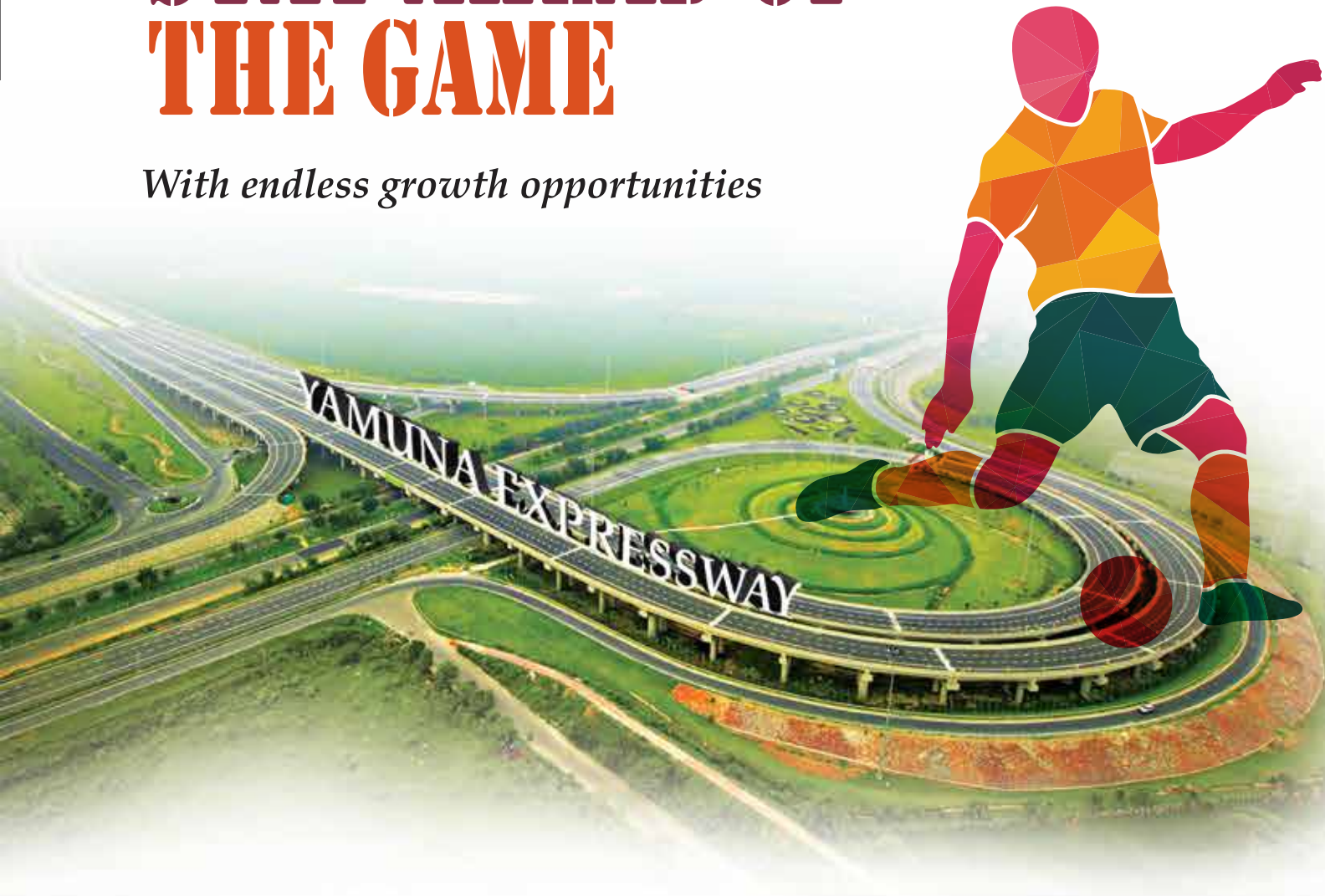

YEIDA stands for Yamuna Expressway Industrial Development Authority and today has the largest industrial land bank even to accommodate the Airport & the proposed Film City in the region which would see rapid development. The initial budget set for YEIDA was Rs. 12,500 crore approximately. With an area of 2,689 sq km under its belt, it is the biggest industrial township project that covers connectivity, industrial development, and infrastructure development. YEIDA also promises to develop smart villages along the 165 km stretch. It is one of the driving forces behind Noida's growth and development. YEIDA's master plan of 2031 predicts rapid and extensive real estate development. Yamuna Expressway is a development that connects Delhi/Noida/Gr. Noida with Western UP/Agra and Lucknow.

Disclaimer:
The image/images used above is for illustrative purposes only. All images including stock images, colours, pictures and accessories are indicative and used for illustrative purposes only. For the actual project details, please refer to the specifications mentioned in the subsequent pages of this brochure.

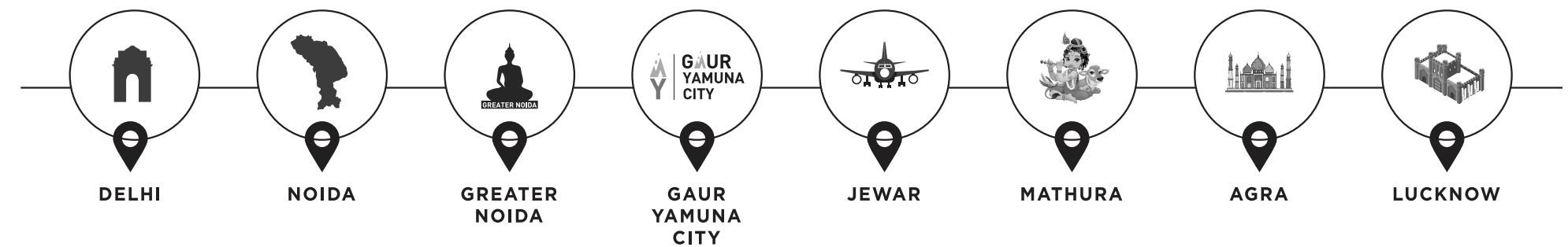

*All information above is in reference from newspapers, websites and news portals.

Truly World Class

Noida International Airport at Jewar, Yamuna Expressway is poised to be India's largest airport and among the world's largest airports. Only the O'Hare International Airport and the Dallas/Fort Worth International Airport are larger, with eight and seven runways respectively. The airport is giving a major fillip to infrastructure, employment creation, demand for residential, commercial, retail, hospitality, while changing the property market dynamics in the region.

- Proposed as a **2-runway airport** by 2022-23
- Future expansion into a **7200-acre 6-runway airport**
- It will handle **5 million passengers per annum** (MPA) initially
- **Up-to 60 MPA** after its expansion over a period of 30 year

LET YOUR DREAMS TAKE FLIGHT

- **JANUARY 2020: LAND ACQUISITION COMPLETED FOR PHASE-1 WHICH REQUIRED 1334 HECTARES OUT OF 5000 HECTARES.**
- **PHASE-1 OF THE AIRPORT PROJECT TO BE COMPLETED BY YEAR 2023.**
- **7 OCTOBER 2020: FINAL AGREEMENT SIGNED BETWEEN NIAL (NOIDA INTERNATIONAL AIRPORT LIMITED) AND ZURICH AIRPORT INTERNATIONAL AG, THE SWISS COMPANY SELECTED TO BUILD NOIDA INTERNATIONAL AIRPORT.**

MAJOR UPDATES

NOIDA INTERNATIONAL AIRPORT AT JEWAR

SUPERFAST CONNECTIVITY

Noida International Airport at Jewar will be connected to the **Yamuna Expressway**, allowing domestic and international tourists to reach Agra, Mathura and Vrindavan. The six-lane road will provide direct connectivity from the Yamuna Expressway to the site of the airport. Also to be connected to **Delhi Metro** via the **Noida Metro route** and via the **Delhi-Faridabad-Ballabhgarh-Palwal-Jewar route**.



*All information above is in reference from newspapers, websites and news portals.

GET READY FOR THE BLOCKBUSTER WIN

INDIA'S 'BIGGEST' FILM CITY

While it will revive the region's fortunes, there will be unprecedented boost to price appreciation and increased infrastructure activity. It will see a spurt in demand for luxury residential, commercial and hospitality segments also, reviving the property market in nearby areas like Noida, Greater Noida and Yamuna Expressway.

- Proposed over a huge 1,000-acre area in Sector 21, situated along the Yamuna Expressway
- 5-6 km approx. from the upcoming Noida International Airport at Jewar



Disclaimer:
The image/images used above is for illustrative purposes only. All images including stock images, colours, pictures and accessories are indicative and used for illustrative purposes only. For the actual project details, please refer to the specifications mentioned in the subsequent pages of this brochure.

Dedicated Infotainment Zone with all world-class civil, public & technological facilities

Industrial area (studios, sets) will spread over 780 acres

The remaining 220 acres for commercial purposes

Comprising outdoor locations, open grounds, food court (s), a shopping complex (es), a theatre & a film university.

Proposed as meticulous development of 5 zones

Government's one-of-the-most ambitious projects

Massive boost to investment, growth & employment



*All information above is in reference from newspapers, websites and news portals.

BE IN A LEAGUE OF YOUR OWN @



A 101 HECTARES (250 ACRES)
INTEGRATED TOWNSHIP
ON YAMUNA EXPRESSWAY

GYC is an integrated township, spread over a massive 101 hectares (250 acres) of land. Thoughtfully planned as one-of-the-biggest amalgamations of residential, commercial, retail, recreation and fun, it is a self-sustained, eco-rich world, ready to offer you a lifestyle that you had been waiting for so many years.



A Complete City

VILLAS,
PLOTS,
APARTMENTS,
EDUCATION,
SHOPPING,
SPORTS,
RECREATION
& MUCH MORE

Disclaimer:
The image/images used above is for illustrative purposes only. All images including stock images, colours, pictures and accessories are indicative and used for illustrative purposes only.
For the actual project details, please refer to the specifications mentioned in the subsequent pages of this brochure.

YAMUNA DWAR - ENTRANCE TO GAUR YAMUNA CITY



ACTUAL IMAGE



**GAUR
YAMUNA
CITY**

**A 101 HECTARES (250 ACRES)
INTEGRATED TOWNSHIP
ON YAMUNA EXPRESSWAY**

RISE TOGETHER IN A 'COMPLETE CITY'

Gaur Yamuna City is an integrated township, spread over a massive 101 hectares (250 acres) of land. Thoughtfully planned as one-of-the-biggest amalgamations of residential, commercial, retail, recreation and fun, it is a self-sustained, eco-rich world, ready to offer you a lifestyle that you had been waiting for so many years.

Plots, Apartments, Retail Shops, Studio Apartments, Themed Villas, Sports, Recreation & a lot more

HIGHLIGHTS

- BEAUTIFUL YAMUNA LAKE PARK WITH BOATING FACILITY.
- POSSESSION STARTED & FAMILIES HAVE MOVED IN THE GROUP HOUSING AND VILLA PROJECTS.
- OPERATIONAL GYC GALLERIA CONVENIENT SHOPPING CENTER
- INDIA'S TALLEST STATUE OF LORD KRISHNA STANDING AT 108 FEET TALL ATOP A TEMPLE (UNDER CONSTRUCTION).
- OPERATIONAL GAURS INTERNATIONAL SCHOOL
- MORE THAN 4 KM. ROAD INFRASTRUCTURE IN PLACE.
- 4 VILLA PROJECTS UNDER DEVELOPMENT.
- RAIN WATER HARVESTING, SEWAGE TREATMENT PLANT AND SOLID WASTE MANAGEMENT SYSTEM
- DEVELOPING CRICKET GROUND, TENNIS, BADMINTON, VOLLEYBALL, BASKETBALL, SKATING RINK, ATHLETIC TRACK & MORE WITHIN THE TOWNSHIP.



ACTUAL IMAGE

KIDS' PARK



ACTUAL IMAGE

GYC GALLERIA SHOPPING COMPLEX



ACTUAL IMAGE



ROAD INFRASTRUCTURE

ACTUAL IMAGE

YAMUNA LAKE PARK



ACTUAL IMAGE



ARTIST'S IMPRESSION

108 FEET LORD KRISHNA STATUE
AND SHRI RADHA KRISHNA TEMPLE
(UNDER CONSTRUCTION)

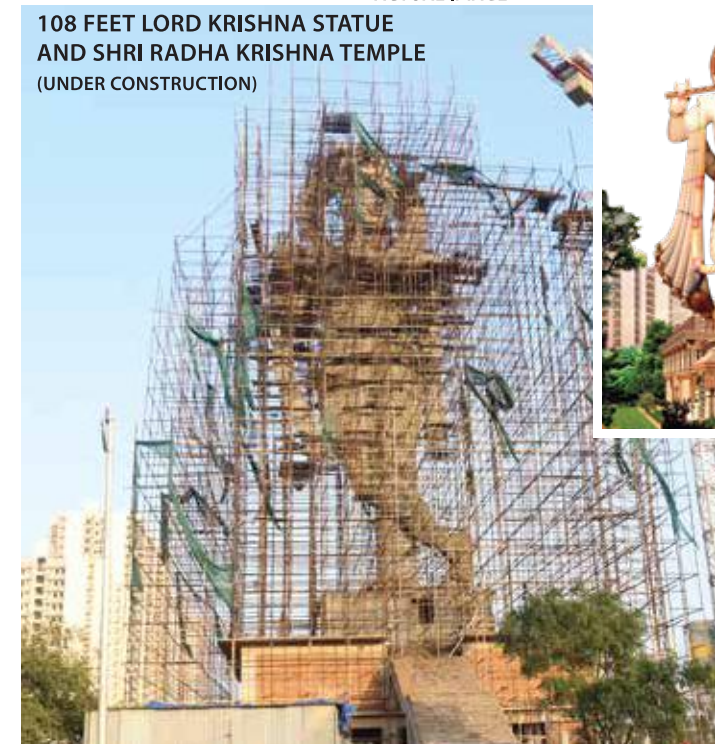

ACTUAL IMAGE



ARTIST'S IMPRESSION

Introducing
7TH PARKVIEW
Luxury By Nature

@

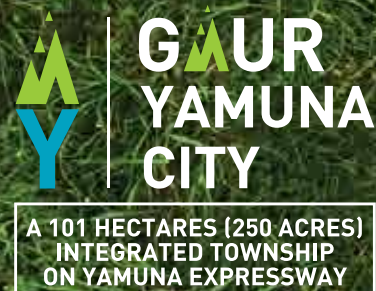

For the first time in real estate journey, Gaur is launching sports stadium facing residential plots. Nestled within relaxed surroundings, its' where you will inhabit your dream world, blessed with world-class amenities and facilities.

- *Experience Resort Style living amidst lush green spaces.*
- *Acres of natural landscape and well-manicured gardens.*
- *Open air environment to feel rejuvenated all the time.*
- *Scenic views of nature and plush stadium for the lifetime.*



BE AMONG THE FRONT-RUNNERS

*Perfect oasis for fitness-enthusiasts
& nirvana seeking residents*

In today's hectic lifestyle, we often ignore the importance of health and wellness. In addition to the lack of time, the absence of fitness facilities only decreases the drive to lead an active life.

Welcome to Sports Villas, which are intelligently designed to bring about a refreshing turnaround in your life with its state-of-the-art sports facilities and amenities.

Introducing

SPORTS VILLAS

*Sports Themed Plots @
7th Parkview | Gaur Yamuna City*



A 101 HECTARES (250 ACRES)
INTEGRATED TOWNSHIP
ON YAMUNA EXPRESSWAY

MASTER PLAN

LEGEND

1. YAMUNA DWAR
2. SANGAM DWAR
3. CAPITOL HILL GATE

A. MASTER PLAN COMMERCIAL

- GAURS RUNWAY SUITES
- THE HUB
- PETROL PUMP
- MULTI LEVEL CAR PARKING
- COMMERCIAL FOOT PRINT

B. SCHOOL / INSTITUTIONAL EDUCATIONAL PLOTS

C. CONVENIENT / SECTOR SHOPPING

- ### D. DISPENSARY
- NURSING HOME (NH)

E. GYC GALLERIA

GR-01. ECO PARK

- LAKE YAMUNA PARK
- CHILDREN PARK
- PICNIC SPOT
- BOATING FACILITIES
- FOOD COURT
- LAKE PROMENADE & BIRD WATCHING

GR-02. RECREATIONAL GREEN AREA (SPORTS PARK)

- OPEN AIR THEATER
- CHILDREN PLAY AREA
- CRICKET GROUND

FACILITIES

- RELIGIOUS PLOT
- MILK BOOTH
- CLUB FACILITIES

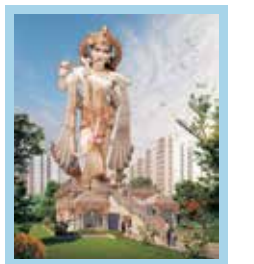
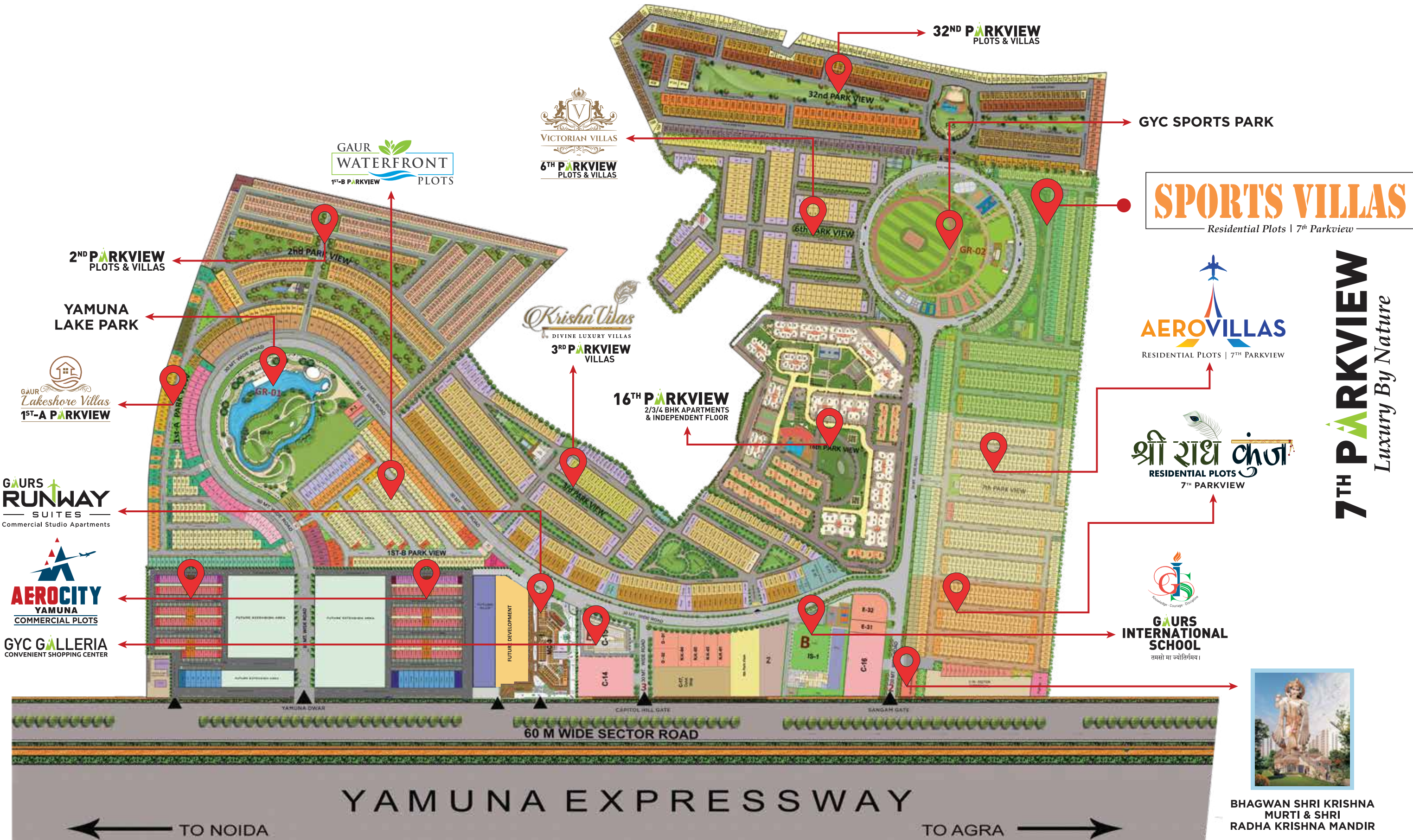
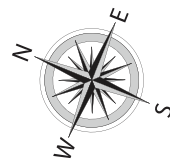

BHAGWAN SHRI KRISHNA MURTI & SHRI RADHA KRISHNA MANDIR

Gaur Realty Pvt. Ltd. Sub Lease Deed of: Part 1 Vide Book No-1, Vol No-13251, Page No-299 to 450, Registration / Document No-11798, Sub Registrar Sadar, Gautambudh Nagar, (U.P.) on 22-05-2013, Part 2 Vide Book No-1, Vol No-14222, Page No-85 to 134, Registration / Document No-24479, Sub Registrar Sadar, Gautambudh Nagar, (U.P.) on 05-10-2013, Part 3 Vide Book No-1, Vol No-14828, Page No-227 to 282, Registration / Document No-781, Sub Registrar Sadar, Gautambudh Nagar, (U.P.) on 09-01-2014, Part 4 Vide Book No-16236, Page No-189 to 242, Registration / Document No-20325, Sub Registrar Sadar, Gautambudh Nagar, (U.P.) on 27-06-2014, Part 5 Vide Book No-1, Vol No- 16526, Page No-107 to 162, Registration / Document No-25183, Sub Registrar Sadar, Gautambudh Nagar, (U.P.) on 31-07-2014, Project Approval No. 6th Parkview: PLG/(BP)-29/40072/2017/27 Dated 15-11-2017, 2nd & 32nd Parkview: Letter No-YEA/PLG/(BP)-62/54470 Dated 31-03-2017, 3rd & 6th Parkview: Letter No-YEA/PLG/(BP)-62/54470 Dated 10-04-2018, Runway Suites: Letter No-YEA/PLG/(BP)-62/54470 Dated 07-02-2019, 7th Parkview: Letter No-YEA/PLG/(BP)-62/54470 Dated 14/10/2020 by Yamuna Expressway Industrial Development Authority, Map sanctioned of Gaur Yamuna City Township Project, vide letter Reg. No. YEA/PLANNING / BP-62/19003/2016 Dated: 31/03/2017, by Yamuna Expressway Industrial Development Authority. All images, perspective specifications, features, figures, are only indicative and not a legal offering. All project related sanctions any other statutory compliance can be seen in person at our office. 1 sq. mtr. = 10.764 sq. ft. 1 acre=4047 sq. mtr. (approx.), 1 sq. yd. = 0.84 sq. mtr. (approx.)



SPORTS VILLAS

Sports Themed Plots | Yamuna Expressway

7TH PARKVIEW

SITE PLAN

LEGEND

PLOT SIZES		NOS.
	103.95 sqmt. (124 sqyd.)	48
	88.20 sqmt. (105 sqyd.)	253
	120.68 sqmt. (144 sqyd.)	8
	143.50 sqmt. (172 sqyd.)	2
	94.78 sqmt. (113 sqyd.)	2
	111.16 sqmt. (133 sqyd.)	1
	123.20 sqmt. (147 sqyd.)	1
	OTHER PLOT AREA* (P-LINE)	3
	121.59 sqmt. (145 sqyd.)	35
	98.0 sqmt. (117 sqyd.)	2
	121.30 sqmt. (145 sqyd.)	1
	138.93 sqmt. (166 sqyd.)	2
	117.88 sqmt. (141 sqyd.)	2

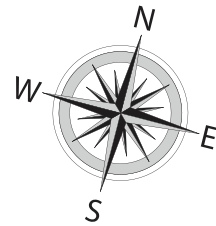

Plot Size, Entry and location - As per GYC-7TH PARK VIEW site plan sanctioned with plot dimension, Plot Entry marked and plot area detail. Plot set back as per YEIDA Authority norms.

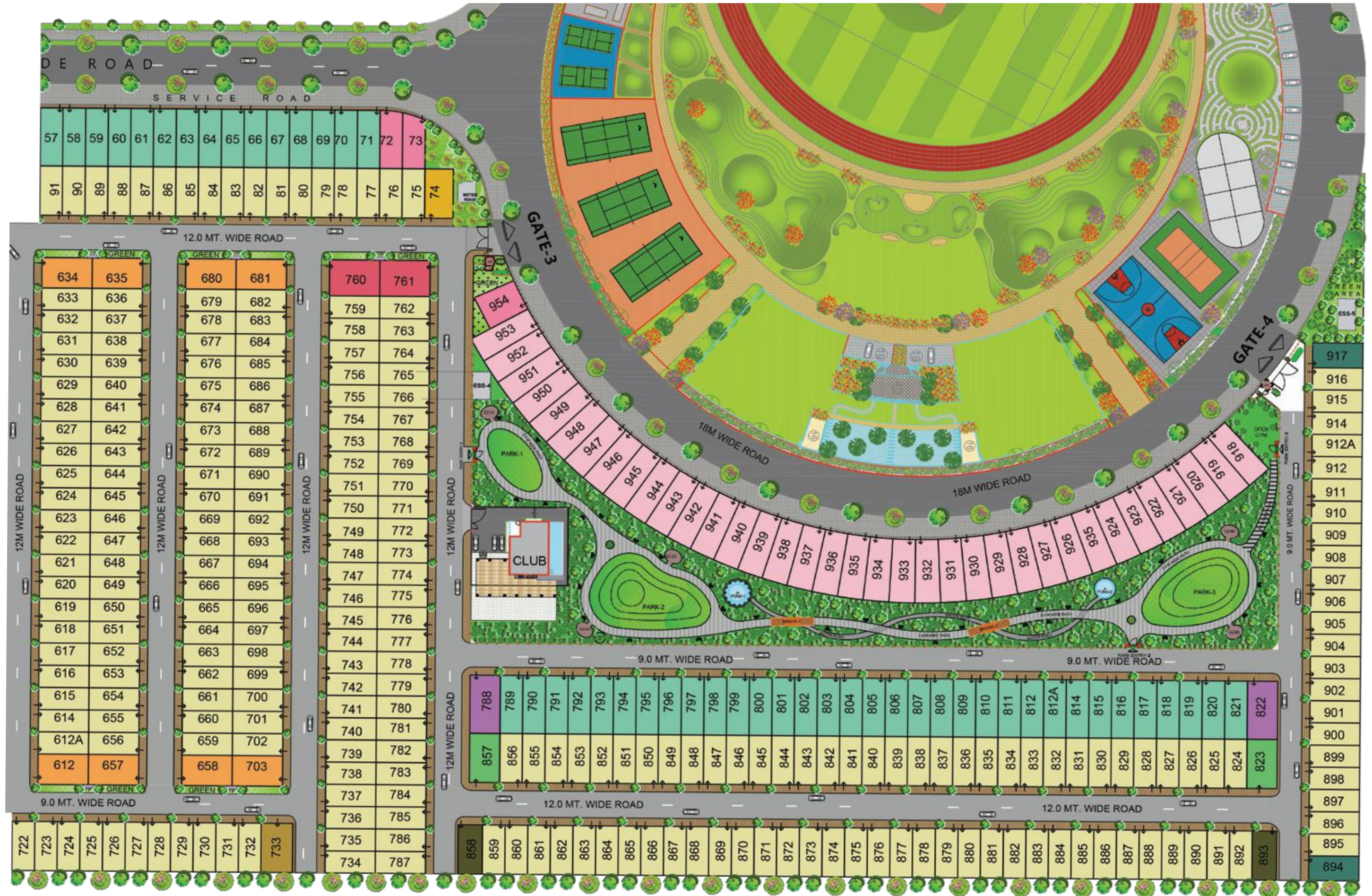

32ND PARKVIEW

Gaur's Realtech Pvt. Ltd. Sub Leases Deed of Part 1 Vide Book No-1, VolI No-13251, Page No-209 to 450, Registration / Document No-11798, Sub Registrar Sadar, Gautambudh Nagar, (U.P.) on 22-05-2013. Part 2 Vide Book No-1, VolI No-14222, Page No-85 to 134, Registration / Document No-24479, Sub Registrar Sadar, Gautambudh Nagar, (U.P.) on 05-10-2013. Part 3 Vide Book No-1, VolI No-14628, Page No-227 to 282, Registration / Document No-7161, Sub Registrar Sadar, Gautambudh Nagar, (U.P.) on 09-01-2014. Part 4 Vide Book No-1, VolI No-15286, Page No-107 to 162, Registration / Document No-23165, Sub Registrar Sadar, Gautambudh Nagar, (U.P.) on 31-07-2014. Project Approval No. 601/PK/View/PLU/IBP/239/4007/2017/22 Dated 15-11-2017. 2nd 82nd Parkview: Letter No-TEA/PLG/IBP/62/1903/2016 Dated 31-05-2017. 3rd & 6th Parkview: Letter No-TEA/PLG/IBP/62/1903/2016 Dated 31-05-2017. 7th Parkview: Letter No-TEA/PLG/IBP/62/1903/2016 Dated 14/10/2020 by Yamuna Expressway Industrial Development Authority. Map sanctioned of Gaur Yamuna City Township Project, vide letter No. TEA/PLANNING/IBP/62/1903/2016 Dated: 31/03/2017. All images, perspective, specifications, features, figures, are only indicative and not a legal offering. All project related sanctions any other statutory compliance can be seen in person at our office. 1 sq. mtr.= 10.764 sq. ft. 1 acre=404 sq. mtr. (approx.)



- Exclusive Yoga Park • Kids' Play Area • Jogging Track
- Open Gym • Beautiful Lake / Water Body

PLOTS FACING STADIUM

WALKABLE DISTANCE TO A PLETHORA OF SPORTS FACILITIES
Developing Cricket Ground, Tennis, Badminton, Volleyball,
Basketball, Skating Rink, Athletic Track & more.



*Disclaimer:
The image/images used above is for illustrative purposes only. All images including stock images, colours, pictures and accessories are indicative and used for illustrative purposes only.
For the actual project details, please refer to the specifications mentioned in the subsequent pages of this brochure.*



Artist's Impression

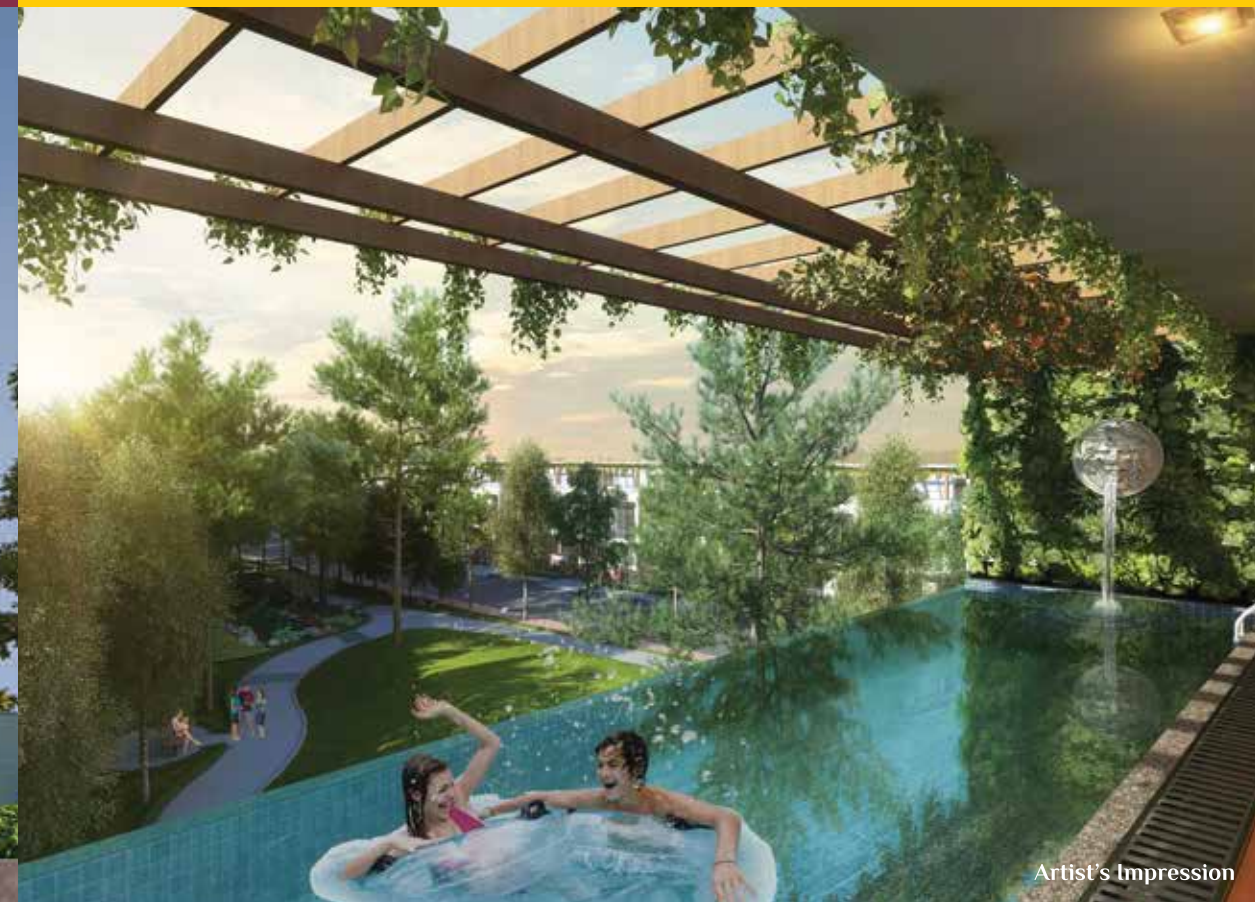

Artist's Impression

SPORTS VILLAS

— Sports Themed Plots @ —
7th Parkview | Gaur Yamuna City

- Outdoor sports – cricket ground, volley-ball, basketball & tennis court, skating rink, jogging track etc.
- Yoga, meditation & outdoor gym.
- Dedicated fitness facilities for kids & the elderly
- Ultra modern Clubhouse

GET OFF TO A FLYING START

with SPORTS LIVING!

Come home to a community brimming with fun, fitness and celebrations. Surround yourself with peace, positivity and pampering. It is intelligently planned with everything you and loved ones need for a healthier and happier living. After all, there is nothing like a sports living.



Artist's Impression

Disclaimer:
The image/images used above is for illustrative purposes only. All images including stock images, colours, pictures and accessories are indicative and used for illustrative purposes only. For the actual project details, please refer to the specifications mentioned in the subsequent pages of this brochure.



Artist's Impression



Artist's Impression

SPORTS VILLAS

Sports Themed Plots @
7th Parkview | Gaur Yamuna City

A BLESSING FOR HEALTH & SPORTS LOVERS

Sports Villas is carefully planned to be your very own sanctuary, meant for the sports lovers and health conscious. Stay close to nature over looking a stadium which will fulfill your thirst for fitness. Perched in the heart of NCR's most happening destination, Gaur Yamuna City at Yamuna Expressway.



Artist's Impression

Disclaimer:

The image/images used above is for illustrative purposes only. All images including stock images, colours, pictures and accessories are indicative and used for illustrative purposes only. For the actual project details, please refer to the specifications mentioned in the subsequent pages of this brochure.

SPORTS VILLAS

Sports Themed Plots @
7th Parkview | Gaur Yamuna City

SUGGESTIVE UNIT PLAN

PLOT AREA:
88.2 SQ. MTR.
(105 SQ. YD.)

Plot Area - 88.2 sq.mtr. (105 sq. yd.)
Total Covered Area of the plot
74.22 + 73.22 + 48.12 = 195.56 sq. mtr.
(798.50) + (788.00) + (517.50) = (2104.00 sq. ft.)

GROUND FLOOR PLAN

Carpet Area	- 53.90 sq. mtr. (580.00 sq. ft.)
External Wall Area	- 5.69 sq. mtr. (61.20 sq. ft.)
COVD. Verandah	- 14.63 sq. mtr. (157.30 sq. ft.)
Total Area	- 74.22 sq. mtr. (798.50 sq. ft.)
Open Area	- 13.98 sq. mtr. (150.40 sq. ft.)

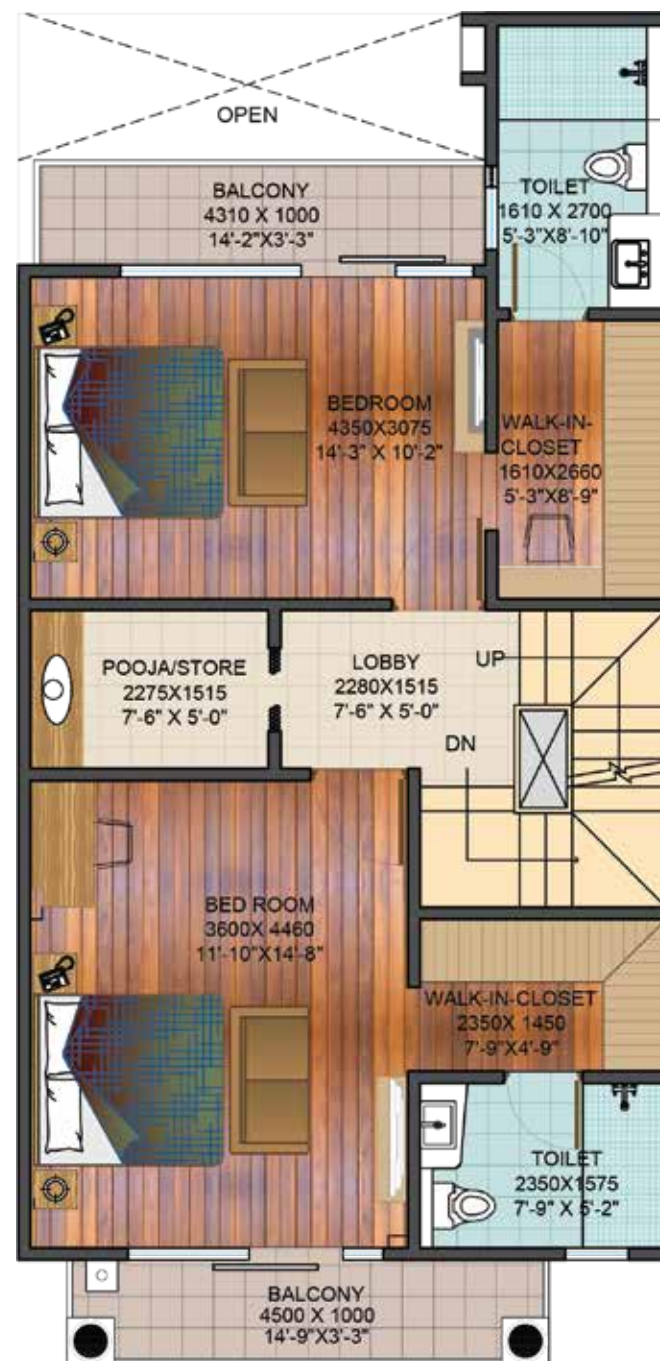

FIRST FLOOR PLAN

Carpet Area	- 60.15 sq. mtr. (647.40 sq. ft.)
External Wall Area	- 4.17 sq. mtr. (44.80 sq. ft.)
Balcony Area	- 8.90 sq. mtr. (95.80 sq. ft.)
Total Area	- 73.22 sq. mtr. (788.00 sq. ft.)



SECOND FLOOR PLAN

Carpet Area	- 40.40 sq. mtr. (434.60 sq. ft.)
External Wall Area	- 3.42 sq. mtr. (36.70 sq. ft.)
Balcony Area	- 4.30 sq. mtr. (46.20 sq. ft.)
Total Area	- 48.12 sq. mtr. (517.50 sq. ft.)

Gaurs Realtech Pvt. Ltd. Sub Lease Deed of:

Part 1 Vide Book No-1, Voll No-13251, Page No-299 to 450, Registration / Document No-11798, Sub Registrar Sadar, Gautambudh Nagar, (U.P.) on 22-05-2013. Part 2 Vide Book No-1, Voll No-14222, Page No-85 to 134, Registration / Document No-24479, Sub Registrar Sadar, Gautambudh Nagar, (U.P.) on 05-10-2013. Part 3 Vide Book No-1, Voll No- 14828, Page No-227 to 282, Registration / Document No-781, Sub Registrar Sadar, Gautambudh Nagar, (U.P.) on 09-01-2014. Part 4 Vide Book No-16236, Page No-189 to 242, Registration / Document No-20325, Sub Registrar Sadar, Gautambudh Nagar, (U.P.) on 27.06.2014. Part 5 Vide Book No-1 Voll No- 16526, Page No-107 to 162, Registration / Document No-25183, Sub Registrar Sadar, Gautambudh Nagar, (U.P.) on 31-07-2014. Project Approval No. 6th Parkview: PLG/(BP)-29/40072/2017/27 Dated 15-11-2017, 2nd & 3rd Parkview: Letter No-YEA/PLG/(BP)-62/19003/2016 Dated 31-03-2017, 3rd & 6th Parkview: Letter No-YEA/PLG/(BP)-62/54470 Dated 10-04-2018. Gaurs Runway Suites: Letter No-YEA/PLG/(BP)-96/79424 Dated 07-02-2019. 7th Parkview: Letter No-YEIDA/PLG/BP-62/901/2020 Dated: 14/10/2020 by Yamuna Expressway Industrial Development Authority. Map sanctioned of Gaur Yamuna City Township Project, vide letter Ref. No. Y.E.A/PLANNING/BP-62/19003/2016 Dated: 31/03/2017.

by Yamuna Expressway Industrial Development Authority.

All images, perspective, specifications, features, figures, are only indicative and not a legal offering. All project related sanctions any other statutory compliance can be seen in person at our office.

1 sq. mtr.= 10.764 sq. ft. 1 acre=4047 sq. mtr. (approx.)

Gaurs Realtech Pvt. Ltd. Sub Lease Deed of:

Part 1 Vide Book No-1, Voll No-13251, Page No-299 to 450, Registration / Document No-11798, Sub Registrar Sadar, Gautambudh Nagar, (U.P.) on 22-05-2013. Part 2 Vide Book No-1, Voll No-14222, Page No-85 to 134, Registration / Document No-24479, Sub Registrar Sadar, Gautambudh Nagar, (U.P.) on 05-10-2013. Part 3 Vide Book No-1, Voll No- 14828, Page No-227 to 282, Registration / Document No-781, Sub Registrar Sadar, Gautambudh Nagar, (U.P.) on 09-01-2014. Part 4 Vide Book No-16236, Page No-189 to 242, Registration / Document No-20325, Sub Registrar Sadar, Gautambudh Nagar, (U.P.) on 27.06.2014. Part 5 Vide Book No-1 Voll No- 16526, Page No-107 to 162, Registration / Document No-25183, Sub Registrar Sadar, Gautambudh Nagar, (U.P.) on 31-07-2014. Project Approval No. 6th Parkview: PLG/(BP)-29/40072/2017/27 Dated 15-11-2017, 2nd & 3rd Parkview: Letter No-YEA/PLG/(BP)-62/19003/2016 Dated 31-03-2017, 3rd & 6th Parkview: Letter No-YEA/PLG/(BP)-62/54470 Dated 10-04-2018. Gaurs Runway Suites: Letter No-YEA/PLG/(BP)-96/79424 Dated 07-02-2019. 7th Parkview: Letter No-YEIDA/PLG/BP-62/901/2020 Dated: 14/10/2020 by Yamuna Expressway Industrial Development Authority. Map sanctioned of Gaur Yamuna City Township Project, vide letter Ref. No. Y.E.A/PLANNING/BP-62/19003/2016 Dated: 31/03/2017.

by Yamuna Expressway Industrial Development Authority.

All images, perspective, specifications, features, figures, are only indicative and not a legal offering. All project related sanctions any other statutory compliance can be seen in person at our office.

1 sq. mtr.= 10.764 sq. ft. 1 acre=4047 sq. mtr. (approx.)

SPECIFICATIONS

7TH PARKVIEW

TOTAL SITE AREA	140063.40 SQM. (34.61 ACRE)
PLOTTED AREA	89750.17 SQM. (22.17 ACRE)
CLUB PLOT AREA	600 SQM. (0.14 ACRE)
GREEN AREA	10372.66 SQM. (2.56 ACRE)
ROAD AREA	39326.80 SQM. (9.71 ACRE)
ESS /CSS	13.77 SQM. (148.21 SQ. FT.)
TOTAL NO. OF PLOTS	954

GREEN AREAS:

- YOGA AREA- Exclusive Yoga Park with a hard paved footpath.
- COMMUNITY AREA- Soft & Hard paved as per detail & design.
 - Kids' Play area.
 - Jogging track & walking track – concrete finish.
 - Open Gym Equipments- 4 nos.
 - Seesaw- 2 nos. , Merry go round- 1 nos. , parallel bars- 1 nos.
 - Seating - 4nos. bench
 - Water Body & landscape features
 - Entry gate- 3 nos.

CLUB [LAND AREA-600 SQM.]:-

- Multipurpose Hall (Ground floor)**
 - Covered Area - 125.4 Sq.mt. (1350 sq.ft. approx)
 - Flooring - Vitrified Tiles
 - Ceiling - POP finished with paint
 - Walls - Paint over Plaster
 - Male & female toilet .
- Indoor play area (on First floor)**
 - Area - 125.4 Sq.mt. (1350 Sq.ft. approx)
 - Flooring - Vitrified Tiles
 - Ceiling - POP finished with paint
 - Walls - Paint over Plaster
 - Table tennis table - 2 No.
 - Pool Table - 1 No.
 - Chess carom board – 2No.
 - Foosball table - 1No.
- Gymnasium & swimming pool with open deck (Second floor)**
 - Area - 83.61 Sq. mt. (900 Sqft.approx:-Gym + open deck area)
 - Flooring - Vitrified Tiles
 - Ceiling - POP finished with paint
 - Walls - Paint over Plaster
 - Equipments - Treadmill - 1 no., Bikes - 1 nos., Benches - 1 no., Dumble with rack - 2 set.
 - Changing Room - Male & Female with shower & w.c. in each with locker.
- Swimming Pool (main)**
 - Pool Size - 14.6m x 3.6m (with independent standalone filter system)
 - Pool depth - 1.1m (max.)
 - Finishes - Tiles
 - Pool deck area - finished with tile flooring
- Under ground water tank [400 KLD]+& pump room [In Club basement].**
- Club Green**
 - Open Party area outside Hall - Natural grass / Shurbs / Plants
 - Lighting - Street Light poles
 - Parking - Paved (As sanction drawing.)
- Staircase - stone flooring as selection & railing as design.**

ESS/CSS & METER ROOM

- Meter room for 7th PARK VIEW.
- ESS/CSS as marked in drawing / capacity as per detail.
- Feeder Pillars Provided In Green strips enclosed by green.
- DG sets only for common area street lights & external common services.

ENTRANCE GATEWAY FOR 7TH PARK VIEW GATE: - 2

- 6m wide opening with M.S gate as detail and design.
- Guard room on ENTRY GATE-2 As per detail.
 - Flooring - Granite stone/ Tile
 - Internal walls - beige tiles till 2.4m from FFL
 - External walls - paint over plaster
 - Doors & windows – UPVC / Aluminium frame with glass
- GRC Jaali on guard room top structure element's as detail and design.
 - LOGO - mounted over Jaali frame as design.
- Entrance Gate [Entry part] - Granite / Sandstone / Paver Block as detail.

GATE: - 3

- 6m wide opening with M.S gate as detail and design. +1.2m wide opening with M.S. wicket gate for Pedestrian as detail & design.
- Guard room + Toilet's for guard on ENTRY GATE-3 As per detail.
 - Flooring - Granite stone/Tile
 - Internal walls - beige tiles till 2.4m from FFL
 - External walls - paint over plaster
 - Doors & windows – Upvc / Aluminium frame with glass
- GRC Jaali on guard room top structure element's as detail and design.
 - LOGO - mounted over Jaali frame as design.
- Entrance Gate [Entry part] - Granite / Sandstone / Paver Block as detail.

GATE: - 4

- 7.5m wide opening with M.S gate as detail and design. +1.2m wide opening with M.S. wicket gate for Pedestrian as detail & design.
- Guard room on ENTRY GATE-4 As per detail.
 - Flooring - Granite stone/Tile
 - Internal walls - beige tiles till 2.4m from FFL
 - External walls - paint over plaster
 - Doors & windows – Upvc / Aluminium frame with glass
- GRC Jaali on guard room top structure element's as detail and design.
 - LOGO - mounted over Jaali frame as design.
- Entrance Gate [Entry part] - area - Granite / Sandstone / Paver Block as detail.

Internal Roads (9m wide right of way & 12m wide right of way):- Interlocking tile / VDF finished road with walking path & street light as per architecture layout .

PROJECTS @ GAUR YAMUNA CITY

ONGOING



ACTUAL IMAGE



3RD PARKVIEW
PLOTS & VILLAS
RERA NO: UPRERAPRJ16103



ACTUAL IMAGE



6TH PARKVIEW
PLOTS & VILLAS
RERA NO: UPRERAPRJ15838



ARTIST'S IMPRESSION



6 URS RUNWAY
SUITES
Commercial Studio Apartments
RERA NO: UPRERAPRJ351477



ARTIST'S IMPRESSION



6 URS RUNWAY
SUITES
Commercial Studio Apartments
RERA NO: UPRERAPRJ351477

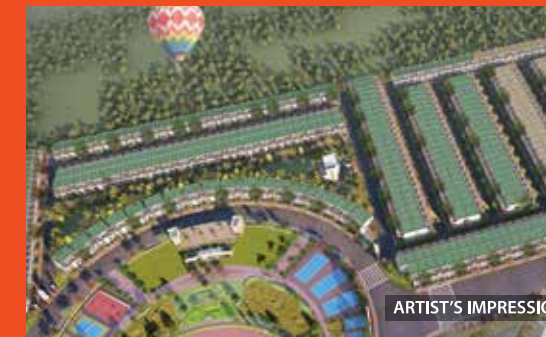

ARTIST'S IMPRESSION



SPORTS VILLAS
Residential Plots | 7th Parkview
RERA NO: UPRERAPRJ16087



ARTIST'S IMPRESSION



श्री रishi कुंज
RESIDENTIAL PLOTS
RERA NO: UPRERAPRJ16087



ARTIST'S IMPRESSION



AEROVILLAS
RESIDENTIAL PLOTS | 7TH PARKVIEW
RERA NO: UPRERAPRJ16087



ARTIST'S IMPRESSION



AERO CITY
YAMUNA
COMMERCIAL PLOTS
RERA NO: UPRERAPRJ342117

DELIVERED



ACTUAL IMAGE

32ND PARKVIEW
RESIDENTIAL PLOTS (VILLAS)
RERA NO: UPRERAPRJ4193



ACTUAL IMAGE

2ND PARKVIEW
RESIDENTIAL PLOTS (VILLAS)
RERA NO: UPRERAPRJ4464



ACTUAL IMAGE

16TH PARKVIEW
2/3/4 BHK APARTMENTS
& INDEPENDENT FLOOR
PHASE-I DELIVERED
RERA NO: UPRERAPRJ6801



ACTUAL IMAGE

GYC GALLERIA
CONVENIENT SHOPPING CENTER
RERA NO: UPRERAPRJ4602

HAPPY TO ANNOUNCE 3RD SCHOOL OPENING AT YAMUNA EXPRESSWAY

ARTIST'S IMPRESSION

ACTUAL IMAGE



Knowledge · Courage · Discipline

GAURS INTERNATIONAL SCHOOL

तमसो मा ज्योतिर्गमय ।
@

GAUR YAMUNA CITY, YAMUNA EXPRESSWAY

AFTER THE SUCCESS OF TWO BRANCHES OF GAURS INTERNATIONAL SCHOOL AT GAUR CITY WITH 3200+ STUDENTS, WE BRING THE PREMIER EDUCATIONAL INSTITUTE TO GAUR YAMUNA CITY. EQUIPPED WITH WORLD-CLASS FACILITIES AMIDST TOP NOTCH INFRASTRUCTURE AND AN INTERNATIONAL CURRICULUM, GAURS INTERNATIONAL SCHOOL BELIEVES IN NURTURING YOUR CHILD IN EVERY ASPECT.

HIGHLIGHTS

- AC CLASSROOMS
- BEST TEACHER STUDENT RATION
- SMART CLASSROOMS WITH PROJECTORS
- AMPHITHEATRE
- MUSIC, ART & DANCE ROOM
- MEDICAL ROOM
- RFID ENABLED ID CARDS
- CBSE BASED CURRICULUM
- CRICKET PITCH
- FOOTBALL
- VOLLEY BALL
- GPS ENABLED BUSES*

ADMISSIONS NOW OPEN FOR SESSION 2021-2022
NURSERY TO 5TH STANDARD

APPROVAL IN PROCESS FOR CLASS 6TH, 7TH & 8TH
www.gaurinternationalschool.com

*PROCURING SOON

SUCCESS FOUNDED ON TRUST

Ever since its inception in the year 1995, Gaur's has been revered as an icon of excellence in the world of real estate. With a burgeoning list of residential projects that encompass high end apartments to highly affordable accommodations occupied by thousands of happy families, Gaur's' stress on customer's trust has become the winning mantra.

The pointed, unerring focus on creating a better tomorrow has been the driving force at Gaur's. It is our foresight, eye for perfect locations and excellence in execution that has earned us a much-deserved success throughout our long journey. And armed with the confidence and verve to enrich lives, one can safely say that the future belongs to Gaur's.



SMART CITY EMPOWERING INDIA AWARDS 2019
BEST SMART CITY DEVELOPER OF THE YEAR
- GAURSONS INDIA



CNBC AWAAZ REAL ESTATE AWARDS 2018-19
BEST RESIDENTIAL PROJECT AFFORDABLE SEGMENT - NORTH ZONE
- GAUR CITY-2



PMAY EMPOWERING INDIA AWARDS 2019
THE MOST WELL PLANNED UPCOMING PROJECT IN EWS CATEGORY
- GAURS SIDDHARTHAM



TIMES BUSINESS AWARDS 2019
BEST REAL ESTATE DEVELOPER OF THE YEAR
- GAURSONS INDIA



CNBC AWAAZ REAL ESTATE AWARDS 2017-18
BEST RESIDENTIAL PROJECT AFFORDABLE SEGMENT - NATIONAL
- GAUR CASCADES



CNBC AWAAZ REAL ESTATE AWARDS 2017-18
BEST RESIDENTIAL PROJECT AFFORDABLE SEGMENT - NORTH INDIA
- GAUR CASCADES



NDTV PROPERTY AWARDS 2016-17
BUDGET APARTMENT PROJECT OF THE YEAR (2017) TIER 1 CITIES
- GAUR CASCADES



NDTV PROPERTY AWARDS 2016-17
BEST TOWNSHIP PROJECT
- GAUR CITY



CNBC AWAAZ REAL ESTATE AWARDS 2016-17
BEST TOWNSHIP PROJECT
- GAUR CITY

THE HALLMARKS TO OUR CREDIT



ONGOING RERA REGISTERED PROJECTS

Gaur Mulberry Mansions, Gr. Noida (West)
UPRERAPRJ7057, UPRERAPRJ4897
KrishnVilas (3rd Parkview)
Gaur Yamuna City **UPRERAPRJ16103**
Gaur's Siddhartham, Siddharth Vihar, Ghaziabad **UPRERAPRJ3935**
Victorian Villas (6th Parkview)
Gaur Yamuna City **UPRERAPRJ15838**
16th Parkview Phase-II,
Gaur Yamuna City **UPRERAPRJ6801**
7th Avenue, Phase-II, Gaur City,
Gr. Noida (West) **UPRERAPRJ6695**

14th Avenue Phase-II, Gaur City-2,
Gr. Noida (West) **UPRERAPRJ6742**
Gaur City Mall Ph-II,
Gr. Noida (West) **UPRERAPRJ6934**
Gaur's Runway Suites,
Gaur Yamuna City **UPRERAPRJ351477**
Gaur City Center Ph-II,
Gr. Noida (West) **UPRERAPRJ4780**
Gaur's Platinum Towers (Gaur Sportswood)
Sector-79, Noida **UPRERAPRJ3528**
Aerocity Yamuna, Gaur Yamuna City
UPRERAPRJ342117

Gaur World SmartStreet,
(Formerly known as Gaur World Street)
Gr. Noida (W) **UPRERAPRJ674297**
7th Parkview, Gaur Yamuna City
Sports Villas
Aero Villas
Shri Radhey Kunj
UPRERAPRJ16087
Gaur Lakeshore Villas (1st-A Parkview),
Gaur Yamuna City **UPRERAPRJ574384**
Gaur Waterfront Plots, (1st-B Parkview),
Gaur Yamuna City **UPRERAPRJ235739**



DELIVERED RESIDENTIAL PROJECTS

Gaur Residency, Chander Nagar
Gaur Galaxy, Vaishali
Gaur Heights, Vaishali
Gaur Ganga, Vaishali
Gaur Ganga 1, Vaishali
Gaur Ganga 2, Vaishali
Gaur Green City, Indirapuram
Gaur Green Avenue, Indirapuram
Gaur Green Vista, Indirapuram
Gaur Valerio, Indirapuram
Gaur Homes, Govindpuram

Gaur Homes Elegante, Govindpuram
Gaur Grandeur, Noida
Gaur Global Village, Crossings Republik
Gaur Gracious, Moradabad
Gaur Cascades, Raj Nagar Extn, Ghaziabad
Gaur Saundaryam, Gr. Noida (West)
1st Avenue, Gaur City
4th Avenue, Gaur City
5th Avenue, Gaur City
6th Avenue, Gaur City
10th Avenue, Gaur City-2

11th Avenue, Gaur City-2
12th Avenue, Gaur City-2
16th Avenue, Gaur City-2
Gaur Sportswood, Sector-79, Noida
Gaur Atulyam, Gr. Noida
14th Avenue, Ph-1, Gaur City-2
7th Avenue, Ph-1, Gaur City
2nd Parkview, Gaur Yamuna City
16th Parkview Phase-1, Gaur Yamuna City
32nd Parkview, Gaur Yamuna City



DELIVERED COMMERCIAL PROJECTS

Gaur Plaza, Shalimar Garden, Ghaziabad
Gaur Residency-Gravity, Chander Nagar, Ghaziabad
Gaur Galaxy-Gravity, Vaishali, Ghaziabad
Gaur Square Govindpuram, Ghaziabad
Gaur Green City-Gravity, Indirapuram, Ghaziabad
Gaur Homes-Gravity, Govindpuram, Ghaziabad
Gaur Heights-Gravity, Vaishali, Ghaziabad
Gaur Ganga-Gravity, Vaishali, Ghaziabad
Gaur Ganga-I-Gravity, Vaishali, Ghaziabad
Gaur Ganga-II-Gravity, Vaishali, Ghaziabad
Gaur Green Vista-Gravity, Indirapuram, Ghaziabad
Gaur Gracious-Gravity, Moradabad
Gaur Global Village-Gravity, NH-24, Ghaziabad
Gaur Grandeur-Gravity, Sector-119, Noida
Gaur Valerio-Gravity, Indirapuram, Ghaziabad

Gaur Cascades-Hi-Street, NH-58, Raj Nagar Extn.
Gaur Central Mall, Rajnagar, Ghaziabad
Gaur High Street (Rajnagar Extn.), Ghaziabad
Gaur Biz Park, Indirapuram, Ghaziabad
Gaur Gravity, Indirapuram, Ghaziabad
Gaur City Plaza, Gaur City, Greater Noida West
Gaur City Galleria, Gaur City, Greater Noida West
Gaur City Arcade, Gaur City, Greater Noida West
GYC Galleria, Gaur Yamuna City, Yamuna Expressway
Gaur Atulyam-Gravity, Gr. Noida
Gaur Saundaryam High-Street, Gr. Noida (W)
Gaur's Sportswood Arcade, Sec-79, Noida
Gaur City Center Phase-I, Gr. Noida (W)
14th Avenue High Street, Gr. Noida (W)



EDUCATION

Gaur's International School
Gaur City-2, Greater Noida (West)
Gaur Yamuna City, Yamuna Expressway
Gaur's Siddhartham, Siddharth Vihar, Ghaziabad (Under Development)



RETAIL

Gaur City Mall, Greater Noida (W)
Gaur Central Mall, RDC, Raj Nagar, Ghaziabad



HOTELS

The Gaur's Sarovar Portico, Gaur City, Gr. Noida West

26
YEARS OF UNFALTERING COMMITMENT

50+
SUCCESSFULLY DELIVERED PROJECTS

20000+
UNITS UNDER DEVELOPMENT

35000+
POSSESSIONS GIVEN (2014-2020)

50000+
DELIVERED UNITS

100000+
HAPPY CUSTOMERS

5500000+
SQUARE METER AREA DEVELOPED

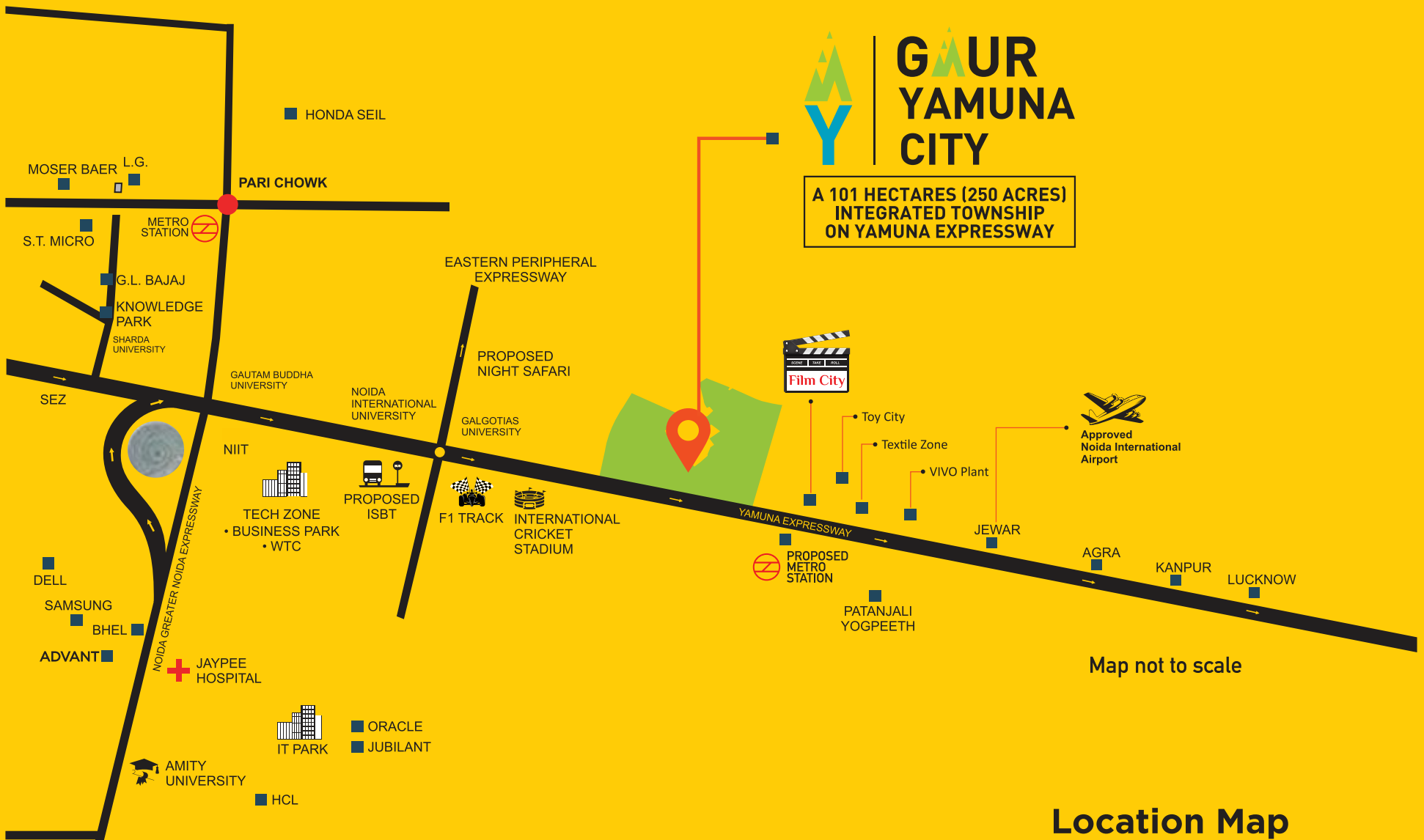

SITE OFFICE: SEC-19, YAMUNA EXPRESSWAY,
DIST. GAUTAM BUDDH NAGAR (U.P.)

CORPORATE OFFICE: GOUR BIZ PARK, PLOT NO-1, ABHAY KHAND II,
INDRAPURAM GHAZIABAD - 201014

RERA REGN. NO.: **UPRERAPRJ16087** | www.up-rera.in

www.gaursonsindia.com



www.gaursonsindia.com

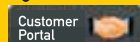

Payment Gateway for existing customers



www.facebook.com/GaursonsIndiaPrivateLimited



www.twitter.com/gaursons_india

Download the Gaursons Mobile App



AFTER SALES **CUSTOMER CARE 1800 180 3052**

REAL ESTATE | RETAIL | EDUCATION | HOTELS | SPORTS | INFRASTRUCTURE | CONTRACTING | MEDIA | ENERGY